

175 First Street S. #1204 • St. Petersburg

FLOOR PLAN

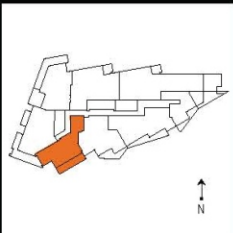

SIGNATURE RESIDENCE D2

2 Bedroom / 2 Bath

Interior 1,027 sq. ft
Terrace 190/289* sq. ft

Residence Total 1,217/1316* sq. ft

*Floors 12-21



SIGNATURE
PLACE TOWER LOFTS PLAZA



Floorplan are for illustration purposes only. All dimensions are approximate, and all floor plans and development plans are subject to change in accordance with and subject to the Condominium Documents.

Marketed by the SIMMS Team, Coastal Properties - See more details at www.SignatureCondoForSale.com

175 First Street S. #1204 • St. Petersburg

AERIAL VIEW



LOCATION, LOCATION, LOCATION

Just blocks from the water, you'll love this downtown St. Petersburg location. Walk to waterfront parks, shops, restaurants, and more. There's easy access to major roadways, including I-275.

Flying in or out? Downtown St. Petersburg is home to Albert Whitted Municipal Airport, a 110 acre general aviation facility. In a half hour, you can be at Tampa International Airport (www.tampaairport.com) or the St. Petersburg/Clearwater International Airport (www.fly2pie.com), which offers general aviation as well as carriers serving destinations in the Northeast, Midwest, South and Canada.